

# INT13-TP1710/P05

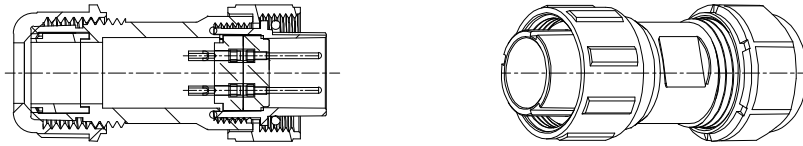
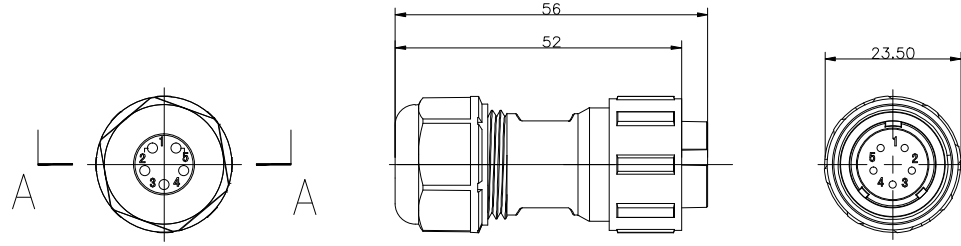

SECTION A-A

## 材料和技术参数 Material and spec

产品类型	Product model	连接器	Connector
接插方式	Coupling	螺纹锁紧	Threaded
外壳材料	Shell material	热塑材料 PP0, PA66	阻燃等级:V-0 PP0, Nylon66 fire resistance:V-0
绝缘体	Insert material	热塑材料 PPS	耐高温 260°C man temperature 260°C
接触件材料	Contact material	铜镀金	Brass with gold plating
接线方式	Termination	INT13-TP17:焊接/压接 INT13-TP17:solder/crimp	
电缆直径	Cable outer diameter range	INT13-TP17A:6-10mm	
防护等级	IP rating	IP68	
接插次数	Mating cycle	500 times	
温度范围	Temperature range	-25 °C — +85 °C	
绝缘电阻MΩ	Insulation resistance M	2000	

## 焊接芯件芯数排列及技术特性表 Solder contact arrangement and spec

芯数 Number of contact	5
插针绝缘体正面图 Male contact face view	
额定电流A Rated current (A)	5A
接触件直径 Contact diameter	1.0*5
接线方式 Termination	焊接/螺丝压接 solder/crimp
工作电压 (AC.V) Rated voltage (AC.V)	500V
耐压 (AC.V) 1 min Test voltage (AC.V) 1 min	1500V
接触电阻 mΩ Contact resistance mΩ	5
线规 mm² /AWG Wire size solder mm² /AWG	<0.785/18.

**INTE-AUTO**

深圳市茵特电子科技有限公司  
SHENZHEN INTE-AUTO CO.,LTD

COMPUTER NO.

INT13-TP17 PULG

UNIT

mm

SCALE

1:1

PART NAMF

INT13-TP1710/P05

MODEL

Waterproof  
Connector

PAGE 1 OF 1

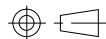

APPD.

Lee

CKD.

LWJ

LZG

DATE

2024/6/1

TOLERANCE

.x ±0.05  
.xx ±0.02

PART NO.

5Pin-Solder

PEV

A0