

INT13-TP2110/P051

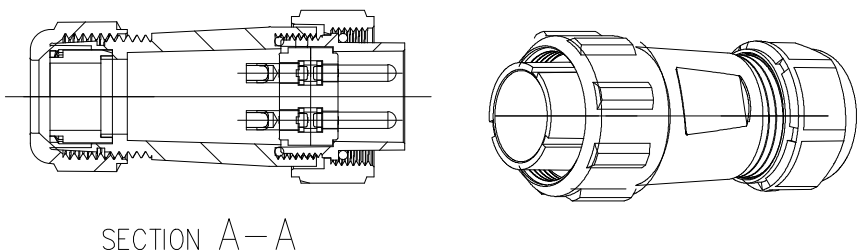
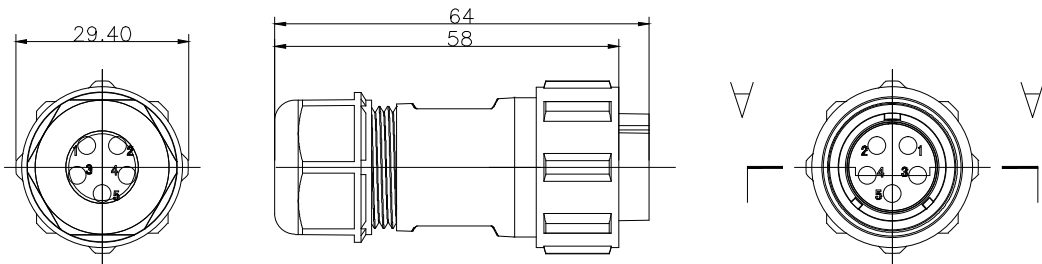

材料和技术参数 Material and spec

| 产品类型 | Product model | 连接器 | Connector |
|--------|----------------------------|--------------------|--|
| 接插方式 | Coupling | 螺纹锁紧 | Threaded |
| 外壳材料 | Shell material | 热塑材料 | PPO, PA66 阻燃等级:V-0 PPO, Nylon66 fire resistance:V-0 |
| 绝缘体 | Insert material | 热塑材料 | PPS 耐高温 260°C PPS man temperature 260°C |
| 接触件材料 | Contact material | 铜镀金 | Brass with gold plating |
| 接线方式 | Termination | INT13-TP21:焊接/压接 | INT13-TP21:solder/crimp |
| 电缆直径 | Cable outer diameter range | INT13-TP21B:7-12mm | |
| 防护等级 | IP rating | IP68 | |
| 接插次数 | Mating cycle | 500 times | |
| 温度范围 | Temperature range | -25 °C -- +85 °C | |
| 绝缘电阻MΩ | Insulation resistance M | 2000 | |

焊接芯件芯数排列及技术特性表 Solder contact arrangement and spec

| | |
|---|-------------------------|
| 芯数 Number of contact | 5A |
| 插针绝缘体正面图 Male contact face view | |
| 额定电流A Rated current (A) | 30A |
| 接触件直径 Contact diameter | 2.8*5 |
| 接线方式 Termination | 焊接/螺丝压接 solder/crimp |
| 工作电压(AC.V) Rated voltage(AC.V) | 500V |
| 耐压(AC.V) 1 min Test voltage(AC.V) 1 min | 1500V |
| 接触电阻 μΩ Contact resistance μΩ | 1 |
| 线规 mm ² /AWG Wire size solder mm ² /AWG | <4.17/11 . |
| 螺丝压接线规 mm ² /AWG Wire size for screw ceimp mm ² /AWG | <1.5/15 . |

INTE-AUTO

深圳市茵特电子科技有限公司
SHENZHEN INTE-AUTO CO.,LTD

COMPUTER NO.

INT13-TP21 PULG

UNIT

mm

SCALE

1:1

PART NAMF

INT13-TP2110/P051

MODEL

Waterproof
Connector

PAGE 1 OF 1

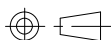

APPD.

Lee

CKD.

LWJ

LZG

DATE

2024/6/1

TOLERANCE
×. ±0.05
.× ±0.02

PART NO.

5Pin-Solder

PEV

A0